

February 20, 2015

CONTACT: Marcia McAllister
T: 703-572-0506
C: 571-730-9117
Marcia.McAllister@dullesmetro.com

**Dulles Corridor Metrorail Project
PHASE 2**

45

REMINDER: Right Lane Closure on Materials Road Begins Feb. 23 at Washington Dulles International Airport

Starting on or about Monday, February 23, Dulles Corridor Metrorail Project crews will close the right turn lane from westbound Materials Road onto northbound Autopilot Drive at Washington Dulles International Airport. The turn lane will be closed for approximately ten days for utility relocation work.

On the day that the concrete barriers are set in place, 5 minute stoppages will occur between 10 a.m. and 2 p.m. in the westbound lane of Materials Road. Flaggers will be in place to direct traffic east of the operation and at the Dollar/Thrifty lot exit. Drivers are asked to exercise caution and remain attentive to signage and barriers at this intersection.

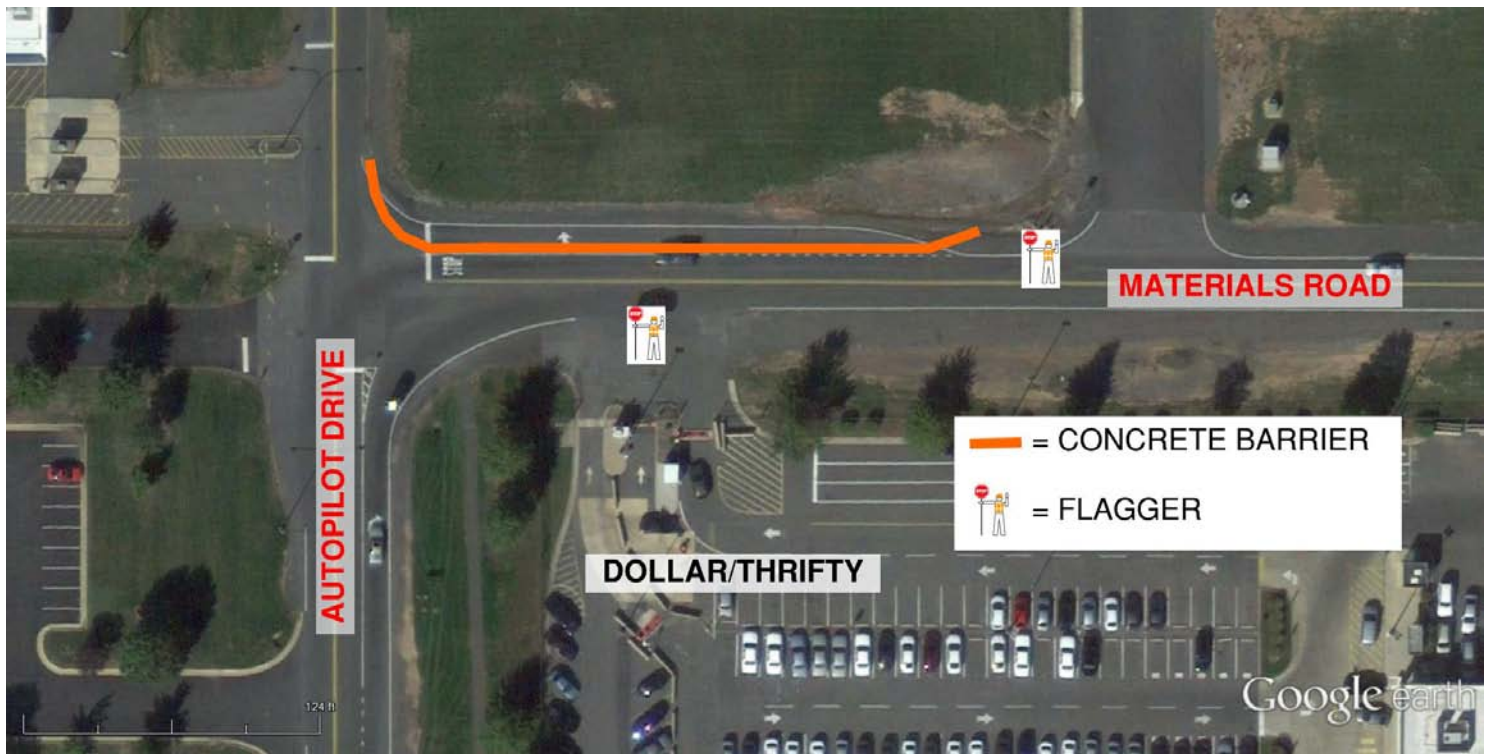

<><><><>

A 24/7 emergency hotline is available for Dulles Corridor Metrorail Project construction-related issues: 844-385-7245.

For general project information: www.dullesmetro.com or 703-572-0506.